



# MONTHLY REPORT

UNIVERSITY OF RICHMOND  
WELL-BEING CENTER & QUEALLY  
ATHLETICS CENTER

OCTOBER 2019

---

**Barton Malow Company**

*Authored by: Eric Follo*

# MAN HOURS AND SAFETY

MAN HOURS	RECORDABLE INCIDENTS
13,567	0

## TOP ACTIVITIES FOR OCTOBER

- Completed a number of concrete slab pours
  - Well-Being Commons/Teaching Kitchen/Café/Vestibule
  - Strength & Conditioning/Sports Med/Hydro
  - West levels 3 and 4 slab on deck
  - Heritage Hall and Mind/Body slab on deck
- Completed structural steel and removed crane from site
- Began exterior wall framing/sheathing
- Began court roof installation
- Court overhead plumbing and roof drain installation
- Completed underground plumbing/electrical installation
- Level 1 spray-applied fireproofing
- Continued mockup construction
- Continued with Millhiser framing and mechanical, plumbing, electrical rough-ins
- First delivery of attic HVAC equipment

## CONTRACTORS ON SITE

CONTRACTOR	TRADE
ETEC	Mechanical & Plumbing
Commercial	Electrical
CT Purcell	Utilities & Earthwork
Piedmont	Concrete
Masonomics	Masonry
Liphart	Steel
Atlantic Contractors	Fire Suppression



---

## AERIAL DRONE PHOTO



\*October aerial drone photo not produced yet. Photo will be distributed to all as soon as it is made available.

# PROGRESS PHOTOS

## Slab on Grade Pours

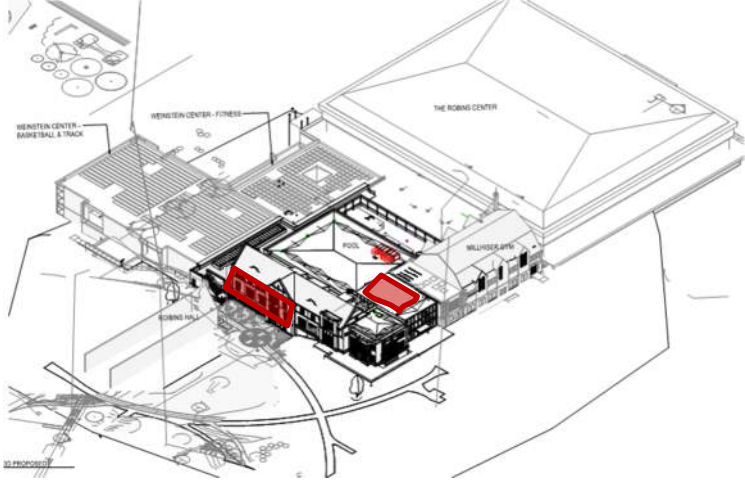





## Heritage Hall and Mind/Body

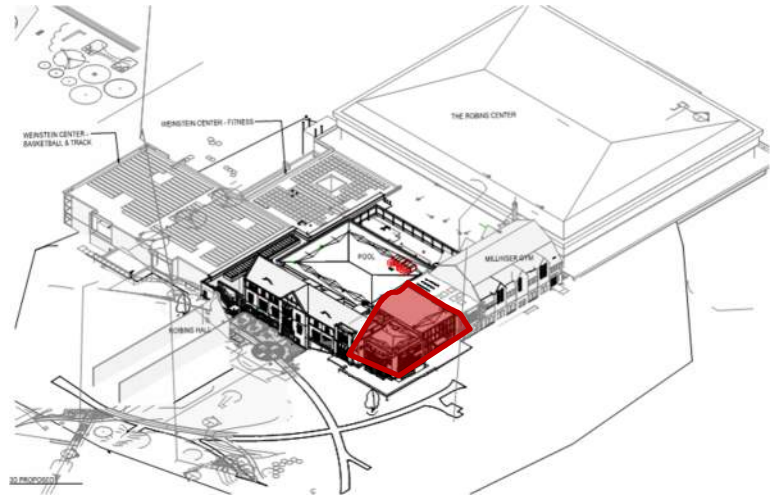





## Exterior Framing/Sheathing

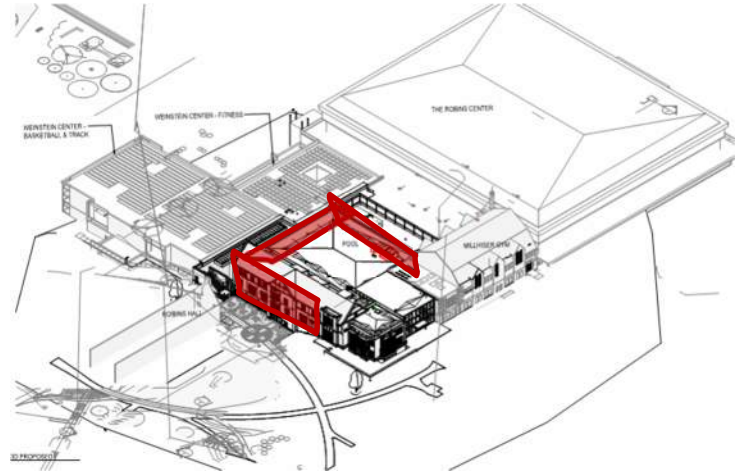



MEP Rough-in

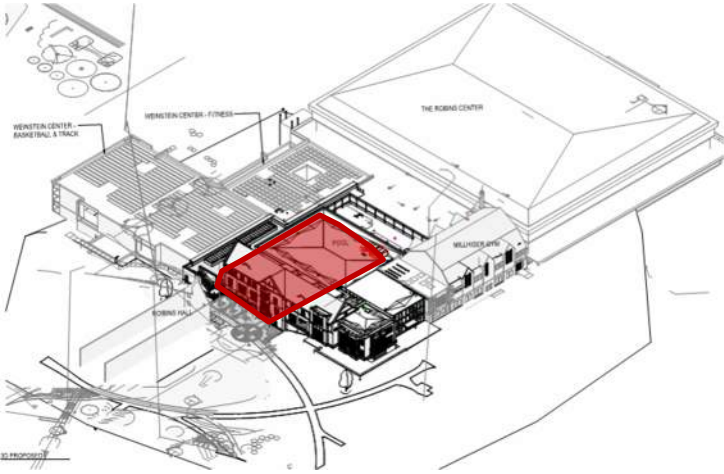

## Court Roofing

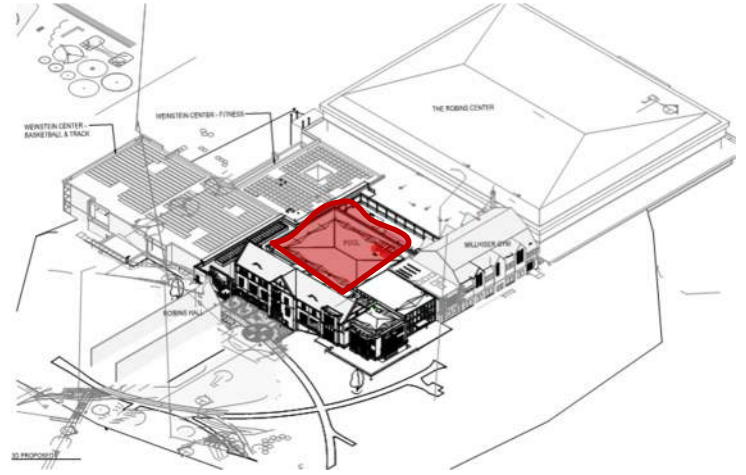



## Attic HVAC Equipment Delivery

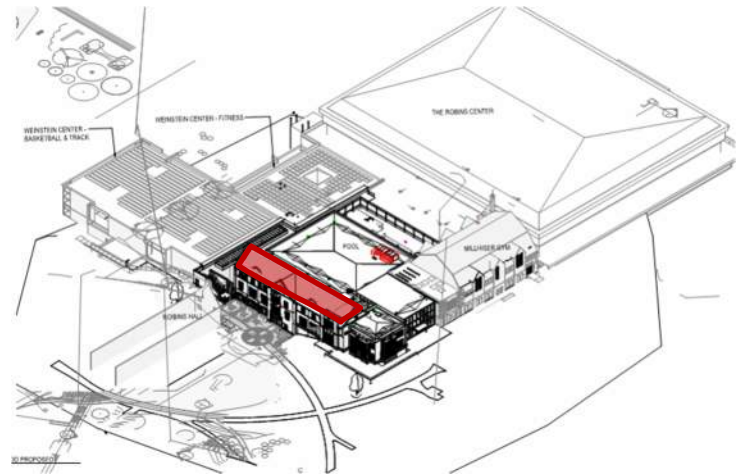

---

## TOP ACTIVITIES FOR NOVEMBER

- Complete remaining concrete slab pours
- Continue exterior wall framing/sheathing
  - Air barrier to follow sheathing
- Frame and deck attic roof
- Begin interior wall framing
- Complete court roof and move to other areas
- Set remaining attic HVAC equipment
- Continue with interior mechanical, plumbing and electrical overhead rough-ins
  - This activity is slated to ramp up this month
- Begin masonry installation
  - Planning to begin at west level 2/3 elevation
- Foundation wall waterproofing and soil backfill
- Continue spray-applied fireproofing
- Complete mockup
- Millhiser – 3<sup>rd</sup> and 4<sup>th</sup> floor duct installation

## UPDATED SCHEDULE

**\*SEE ATTACHED SCHEDULE\***



Activity ID	Activity Name	Original Duration	Start	Finish	2018												2019												2020												2021		
					Jan	Feb	Mar	Apr	May	Jun	Jul	Aug	Sep	Oct	Nov	Dec	Jan	Feb	Mar	Apr	May	Jun	Jul	Aug	Sep	Oct	Nov	Dec	Jan	Feb	Mar	Apr	May	Jun	Jul	Aug	Sep	Oct	Nov	Dec	Jan	Feb	Mar
<b>University of Richmond - Basketball Practice &amp; Wellness Center</b>		454	10-Dec-18A	22-Sep-20																																					22-Sep-20, University of Richmond -		
<b>Long Lead Procurement</b>		317	10-Dec-18A	13-Mar-20																																					13-Mar-20, Long Lead Procurement		
<b>New Construction</b>		291	05-Aug-19A	22-Sep-20																																					22-Sep-20, New Construction		
<b>Mobilizations/Site Preparations/Building Foundations</b>		20	25-Oct-19 A	21-Nov-19																																					21-Nov-19, Mobilizations/Site Preparations/Building Foundations		
A3570	Waterproofing Foundation Walls East	10	25-Oct-19 A	07-Nov-19																																					Waterproofing Foundation Walls East		
A4210	11 Line CMU East Wall/Waterproof/Backfill	7	25-Oct-19 A	07-Nov-19																																					11 Line CMU East Wall/Waterproof/Backfill		
A3740	Foundation Drain East	5	08-Nov-19	14-Nov-19																																					Foundation Drain East		
A4220	Concrete SOG Pour & Prep SEQ 9 & Cafe Leaveout	5	08-Nov-19	14-Nov-19																																					Concrete SOG Pour & Prep SEQ 9 & Cafe Leaveout		
A3750	Backfill Foundation Wall East	5	15-Nov-19	21-Nov-19																																					Backfill Foundation Wall East		
<b>Building Structure</b>		5	01-Nov-19	07-Nov-19																																					07-Nov-19, Building Structure		
A1250	Steel Erection Seq 5 (Robins Roof)	5	01-Nov-19	07-Nov-19																																					Steel Erection Seq 5 (Robins Roof)		
<b>Building Enclosure</b>		93	17-Oct-19 A	03-Mar-20																																					03-Mar-20, Building Enclosure		
A3140	Flat Roof Over Court	15	17-Oct-19 A	08-Nov-19																																					Flat Roof Over Court		
A1270	South Elevation - Exterior CFMF Framing/Sheathing	15	23-Oct-19 A	08-Nov-19																																					South Elevation - Exterior CFMF Framing/Sheathing		
A1390	Attic Roof Framing CFMF/Decking	15	01-Nov-19 A	18-Nov-19																																					Attic Roof Framing CFMF/Decking		
A4060	West Elevation Air Barrier	7	01-Nov-19	11-Nov-19																																					West Elevation Air Barrier		
A1300	East Elevation - Exterior CFMF Framing/Sheathing	14	11-Nov-19	02-Dec-19																																					East Elevation - Exterior CFMF Framing/Sheathing		
A4230	Gable CFMF Frame and Sheath	5	11-Nov-19	15-Nov-19																																					Gable CFMF Frame and Sheath		
A1350	West Elevation - Masonry/Precast	20	12-Nov-19	11-Dec-19																																					West Elevation - Masonry/Precast		
A4050	North Elevation Air Barrier	5	12-Nov-19	18-Nov-19																																					North Elevation Air Barrier		
A3040	North Elevation Stucco	10	19-Nov-19	04-Dec-19																																					North Elevation Stucco		
A3170	Slate Roof - Attic Level	20	19-Nov-19	18-Dec-19																																					Slate Roof - Attic Level		
A3180	Flat Roof - East Side	15	19-Nov-19	11-Dec-19																																					Flat Roof - East Side		
A4070	South Elevation Air Barrier	12	19-Nov-19	06-Dec-19																																					South Elevation Air Barrier		
A1370	North Elevation - Storefront	5	05-Dec-19	11-Dec-19																																					North Elevation - Storefront		
A4080	East Elevation Air Barrier	5	09-Dec-19	13-Dec-19																																					East Elevation Air Barrier		
A1290	South West Elevation - Masonry/Precast	20	12-Dec-19	14-Jan-20																																					South West Elevation - Masonry/Precast		
A1340	West Elevation - Windows	5	12-Dec-19	18-Dec-19																																					West Elevation - Windows		
A3150	Flat Roof - West 2nd Floor Level	15	12-Dec-19	07-Jan-20																																					Flat Roof - West 2nd Floor Level		
A1310	East Elevation - Curtain Wall	10	16-Dec-19	02-Jan-20																																					East Elevation - Curtain Wall		
A1280	South Elevation - Windows	15	08-Jan-20	28-Jan-20																																					South Elevation - Windows		
A1380	North & West Elevation - Metal Panels	30	08-Jan-20	18-Feb-20																																					North & West Elevation - Metal Panels		
A3470	South East Elevation - Masonry & Precast	20	15-Jan-20	11-Feb-20																																					South East Elevation - Masonry & Precast		
A1320	East Elevation - Masonry/Precast	15	12-Feb-20	03-Mar-20																																					East Elevation - Masonry/Precast		
<b>Milheiser Fit-Out</b>		214	05-Aug-19A	05-Jun-20																																					05-Jun-20, Milheiser Fit-Out		
A3460	ROTC Fire Sprinkler Piping	7	05-Aug-19A	01-Nov-19																																					ROTC Fire Sprinkler Piping		
A2140	MEP In Wall Rough-Ins 3rd Floor	15	18-Sep-19A	01-Nov-19																																					MEP In Wall Rough-Ins 3rd Floor		
A3350	4th Floor O/H Piping	15	01-Nov-19	21-Nov-19																																					4th Floor O/H Piping		
A3910	3rd Floor Sprinkler	15	01-Nov-19	21-Nov-19																																					3rd Floor Sprinkler		
A3920	3rd Floor O/H Duct	25	01-Nov-19	09-Dec-19																																					3rd Floor O/H Duct		
A3950	4th Floor O/H Elec	15	01-Nov-19	21-Nov-19																																					4th Floor O/H Elec		
A3960	4th Floor O/H Duct	25	01-Nov-19	09-Dec-19																																					4th Floor O/H Duct		
A4030	3rd Floor Restrooms In-Wall Rough-In	5	01-Nov-19	07-Nov-19																																					3rd Floor Restrooms In-Wall Rough-In		
A3370	New Arch Window Demo	5	09-Dec-19	13-Dec-19																																					New Arch Window Demo		
A2130	Interior Framing 4th Floor	10	10-Dec-19	23-Dec-19																																					Interior Framing 4th Floor		
A3930	3rd Floor O/H Elec	15	10-Dec-19	03-Jan-20																																					3rd Floor O/H Elec		
A3940	4th Floor O/H Sprinkler	15	10-Dec-19	03-Jan-20																																					4th Floor O/H Sprinkler		
A2160	Arch Window Install	15	16-Dec-19	09-Jan-20																																					Arch Window Install		
A3340	MEP In Wall Rough-Ins 4th Floor	15	26-Dec-19	17-Jan-20																																					MEP In Wall Rough-Ins 4th Floor		
A3980	One Side Sheetrock 4th Floor	10	26-Dec-19	10-Jan-20																																					One Side Sheetrock 4th Floor		
A4040	4th Floor Restrooms In-Wall Rough-In	5	26-Dec-19	03-Jan-20																																					4th Floor Restrooms In-Wall Rough-In		
A3360	3rd Floor O/H Piping	20	20-Jan-20	14-Feb-20																																					3rd Floor O/H Piping		
A3970	One Side Sheetrock 3rd Floor	10	03-Feb-20	14-Feb-20																																					One Side Sheetrock 3rd Floor		



**University of Richmond -  
Basketball Practice Wellness  
Center**







